

Project Name		Customer Name	
Quote Number		Date	
Available in Left or Right Wall/Seat Placement*			
Customization			

*Wall/seat placement determined as if standing outside the unit looking in

Standard Features

Type	Two-piece alternate roll-in type shower stall with simulated 12" x 24" tile. Available in left or right hand configuration
Color	White
Exterior Dimensions	63"W x 39"D x 79-5/8"H
Materials	Gel coat and fiberglass composite
Approximate Weight	175 lbs

Certifications and Accessibility Code Compliance



Universal
Plumbing
Code



CSA B45.5-11 / IAPMO
Z124-2017



ADA



ANSI

ICC A117.1
- 2017 ANSI
Type A



California
Title 24

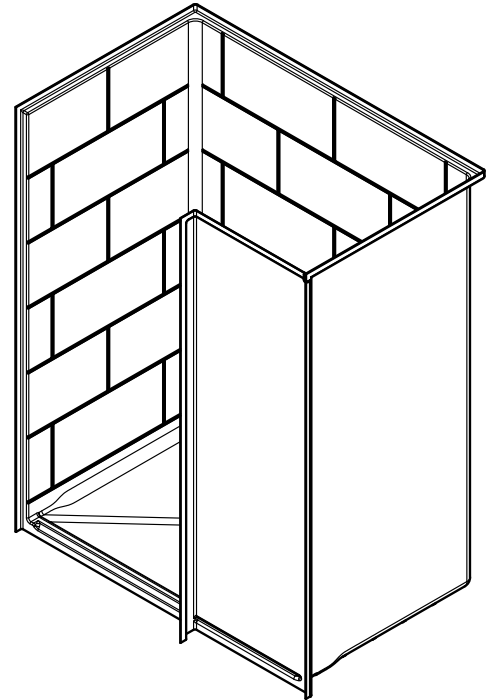

Warranty

30 Year Limited

Reinforcement

Fully reinforced with EverFab's unique composite core material which allows for factory or field installation of ADA compliant grab bars and seat

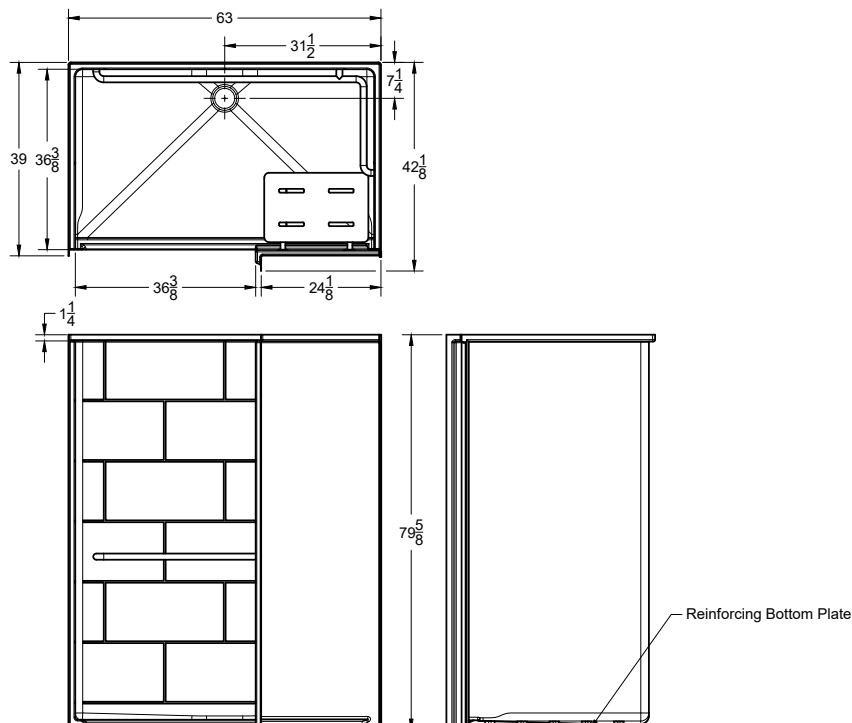

ADA Accessory Dimensions

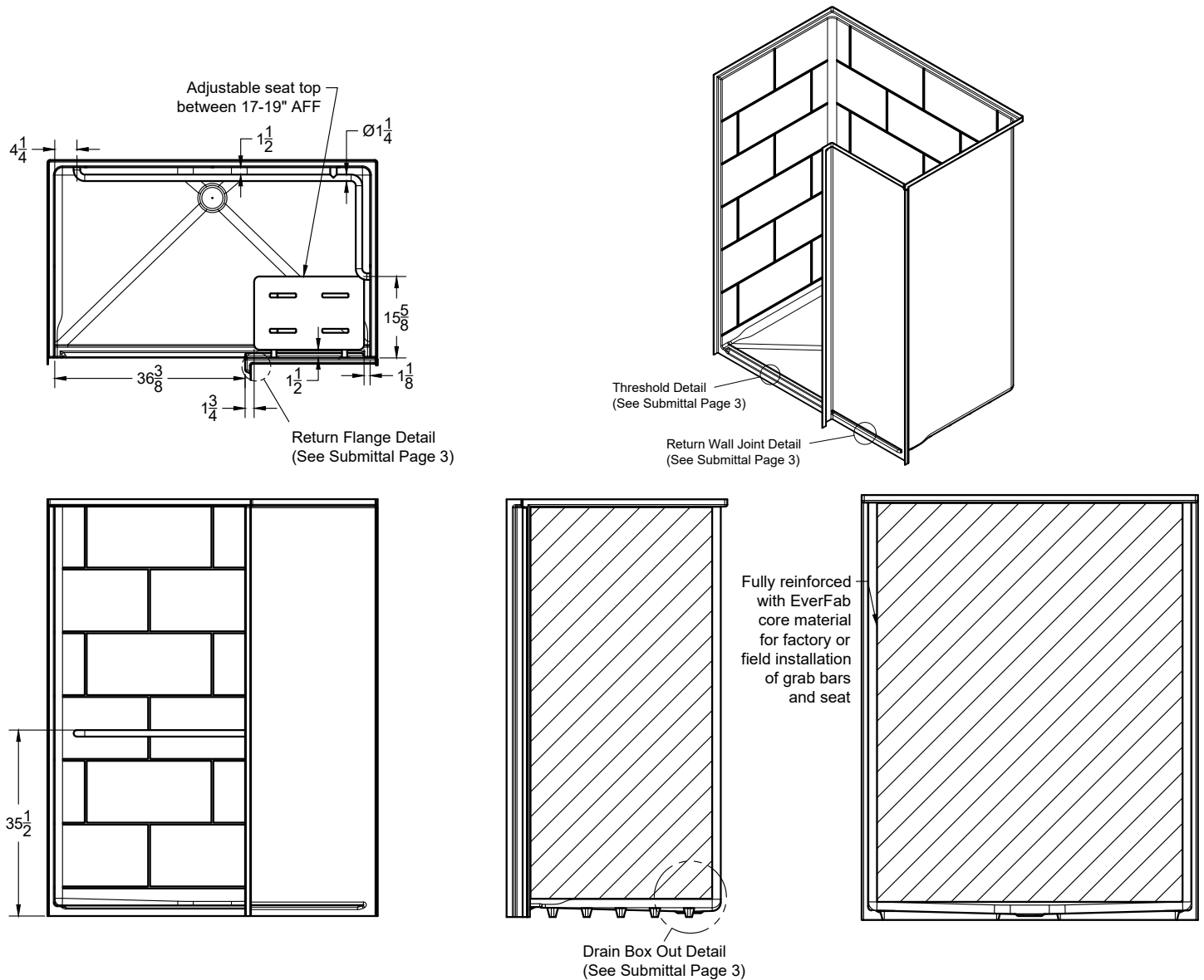

Architectural Specifications

A. Shower Stall:

1. Model: No. S6339RWTa-L/R
2. Description: Two-piece shower stall with reinforcing bottom plate, slip-resistant floor, return wall, 1/8" interior drop for water retention, 12" x 24" simulated tile, and inorganic composite reinforcement for placement of grab bars and seat
3. Exterior dimensions: 63 inches wide x 39 inches deep x 79-5/8 inches high
4. Threshold: [Standard] [Low Profile] [No Recess] Threshold Detail
5. Accessory Configuration: Model [A0] [A1]
6. Optional Accessories: Furnish with [curtain rod], [shower curtain], [recessed soap dish], [rubber dam], [stainless steel semi-permanent threshold], [shower slide-bar kit], [EverFab tub-wrap], [shower drain]

ADA Accessory Configurations (number following 'A' indicates configuration)

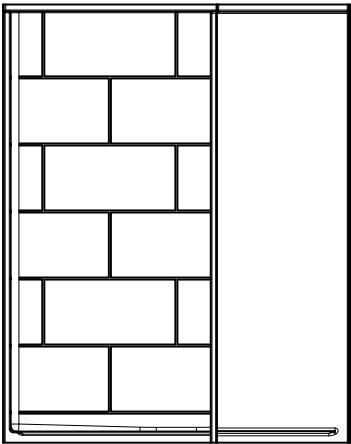

S6339RWTAA0-R
No Accessories

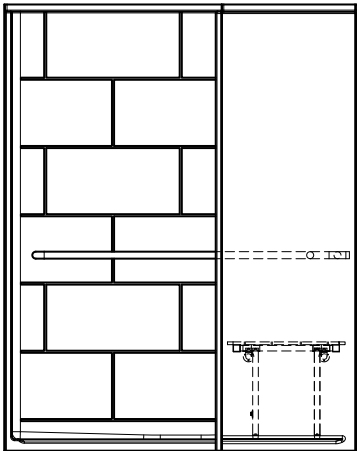

S6339RWTAA1-R
L-shaped grab bar
Seat

Threshold Details

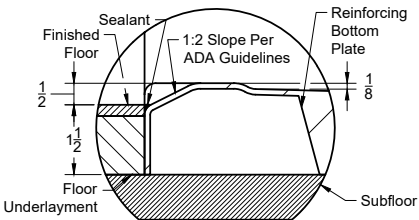

Standard

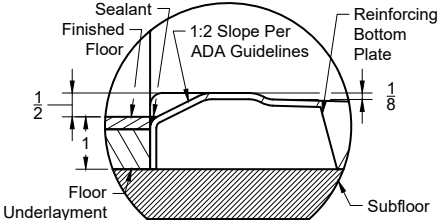

Low-Profile

Model number followed with 'LP'

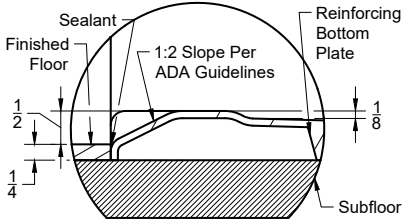

No-Recess

Model number followed with 'NR'

Additional Details

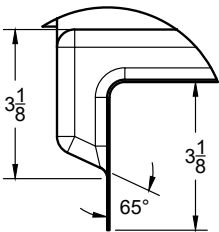

Return Flange

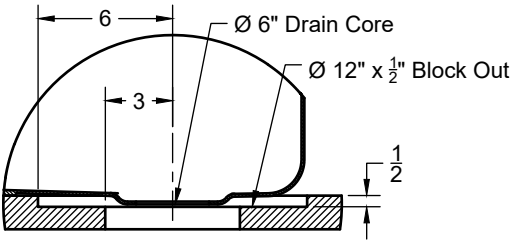

Drain Block-Out

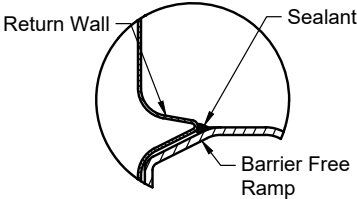

Return Wall Joint

Standard Threshold Models

Model Number	Pre-Installed 1-1/4" L-Shaped Grab Bar	Pre-Installed Folding Seat	Drain Block Out Required	Accessibility Code Compliance
<input type="checkbox"/> S6339RWTa0-L/R	No	No	No	Adaptable**
<input type="checkbox"/> S6339RWTa1-L/R*	Yes	Yes	No	ADA, ANSI, CA Title 24

*Model shown in drawings - S6339RWTa1-R

Low Profile Threshold Models

Model Number	Pre-Installed 1-1/4" L-Shaped Grab Bar	Pre-Installed Folding Seat	Drain Block Out Required	Accessibility Code Compliance
<input type="checkbox"/> S6339RWTa0LP-L/R	No	No	Yes	Adaptable**
<input type="checkbox"/> S6339RWTa1LP-L/R	Yes	Yes	Yes	ADA, ANSI, CA Title 24

No-Recess Threshold Models

Model Number	Pre-Installed 1-1/4" L-Shaped Grab Bar	Pre-Installed Folding Seat	Drain Block Out Required	Accessibility Code Compliance
<input type="checkbox"/> S6339RWTa0NR-L/R	No	No	Yes	Adaptable**
<input type="checkbox"/> S6339RWTa1NR-L/R	Yes	Yes	Yes	ADA, ANSI, CA Title 24

**Model is reinforced and capable of meeting accessibility code requirements with proper field-installation of grab bars and seat

Optional Accessories

- ☐ Curtain Rod
- ☐ Shower Curtain
- ☐ Recessed Soap Dish
- ☐ Shower Slide-Bar Kit
- ☐ EverFab Tub-Wrap
- ☐ Shower Drain