

Project Name		Customer Name	
Quote Number		Date	
Customization			

Standard Features

Type	Two-piece alternate roll-in type shower stall. Available in left or right hand configuration.
Color	White
Exterior Dimensions	63"W x 39"D x 79-5/8"H
Materials	Gel coat and fiberglass composite
Approximate Weight	190 lbs

Certifications and Accessibility Code Compliance



Universal
Plumbing
Code



CSA B45.5-11 / IAPMO
Z124-2017



ADA

ANSI

ICC A117.1
- 2017 ANSI
Type A



California
Title 24



HUD / FHA

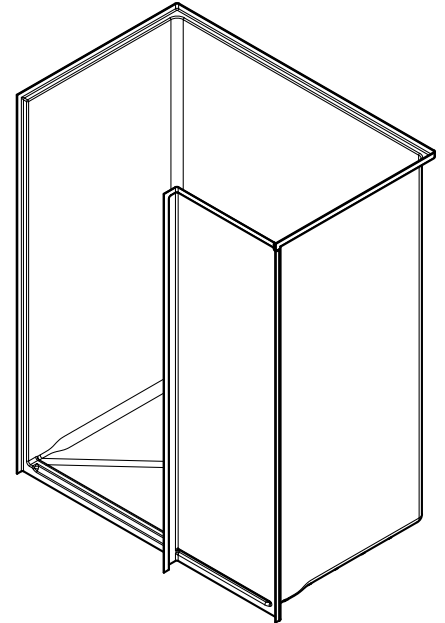

Warranty

30 Year Limited

Reinforcement

Fully reinforced with EverFab's unique composite core material which allows for factory or field installation of ADA compliant grab bars and seat

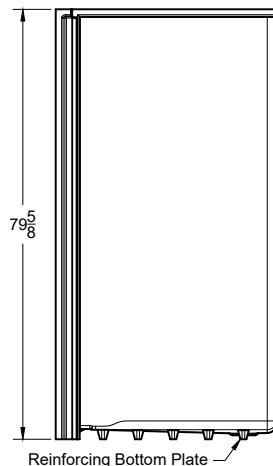
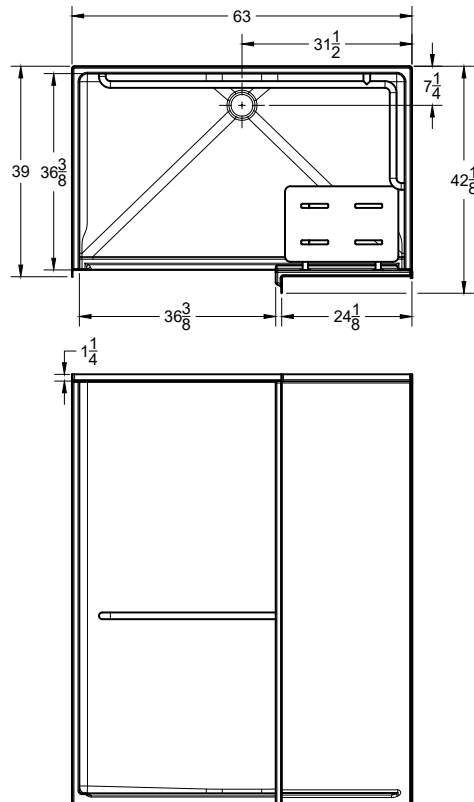

ADA Accessory Dimensions

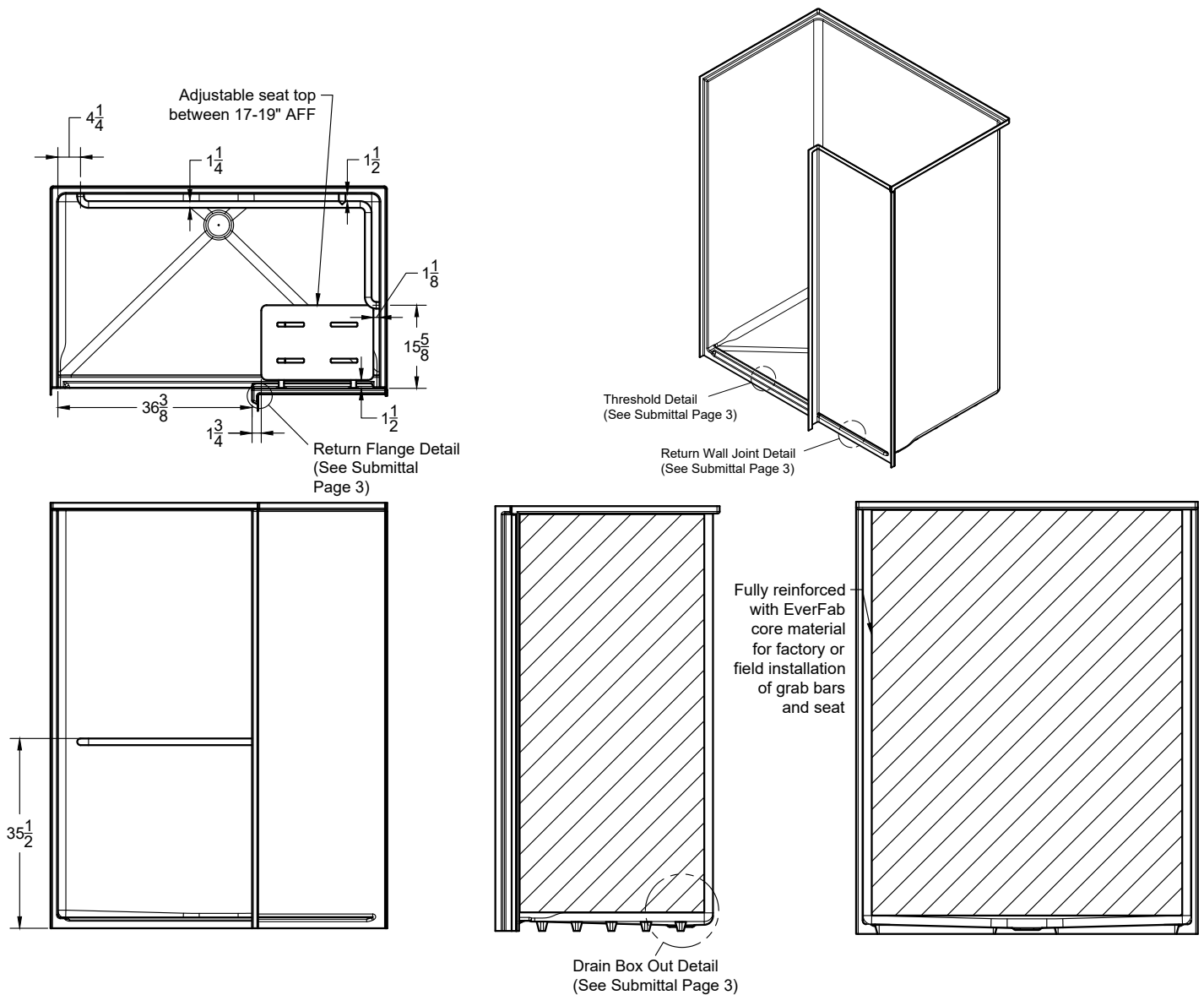

Architectural Specifications

A. Shower Stall:

1. Model: No. S6339RWA-L/R
2. Description: Two-piece shower stall with reinforcing bottom plate, slip-resistant floor, return wall, 1/8" interior drop for water retention, and inorganic composite reinforcement for placement of grab bars and seat
3. Exterior dimensions: 63 inches wide x 39 inches deep x 79-5/8 inches high
4. Rough-in: +1/8" -0" nominal dimensions
5. Threshold: [Standard] [Low Profile] [No-Recess] Threshold Detail
6. Accessibility Accessories: [A0] [A1] [Custom] accessory configuration
7. Optional Accessories: Furnish with [curtain rod], [shower curtain], [recessed soap dish], [composite corner shelf], [shower slide-bar kit], [EverFab tub-wrap], [shower drain], [18" grab bar], [24" grab bar], [folding seat], [T-shaped EverDam]. If applicable, please indicate location of additional accessories on drawing
8. Accessory Style: [A0 - No Accessories], [Standard Thru-Bolted], [Flanged], [Elite Series], [Anti-Ligature], [Custom]
9. Accessory Finish: [A0 - No Accessories], [Standard Satin Stainless], [Matte Black], [Polished Stainless] [White], [Custom]

ADA Accessory Configurations (number following 'A' indicates configuration)

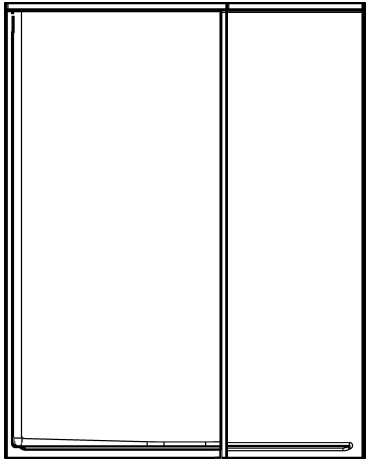

S6339RWA0-R

No Accessories

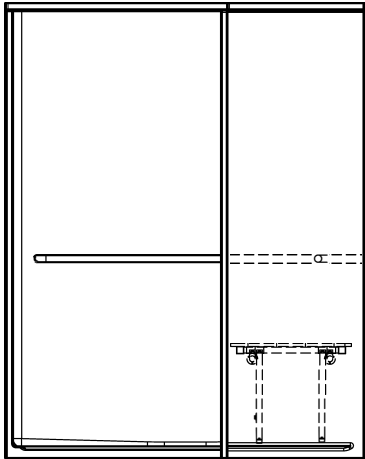

S6339RWA1-R

L-shaped grab bar
Seat

Threshold Details

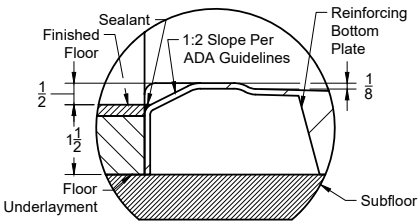

Standard

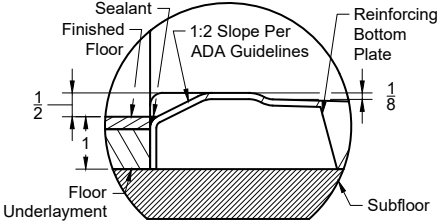

Low-Profile

Model number followed with 'LP'

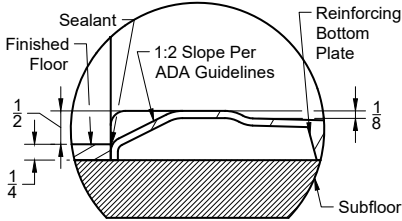

No-Recess

Model number followed with 'NR'

Additional Details

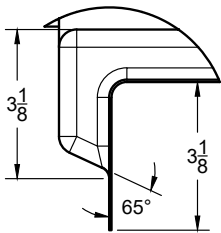

Return Flange

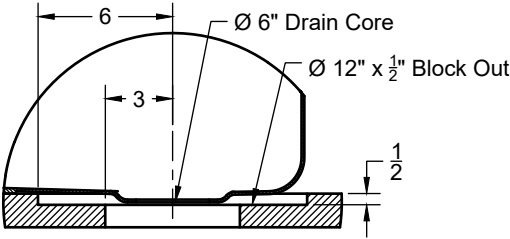

Drain Block-Out

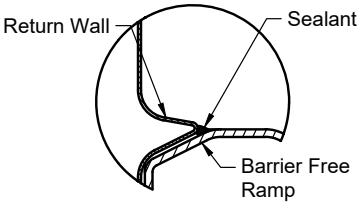

Return Wall Joint

Standard Threshold Models

Model Number	Pre-Installed L-Shaped Grab Bar	Pre-Installed Folding Seat	Drain Block Out Required	Accessibility Code Compliance
<input type="checkbox"/> S6339RWA0	No	No	No	Adaptable**
<input type="checkbox"/> S6339RWA1*	Yes	Yes	No	ADA, ANSI, CA Title 24, HUD/FHA

Low Profile Threshold Models

Model Number	Pre-Installed L-Shaped Grab Bar	Pre-Installed Folding Seat	Drain Block Out Required	Accessibility Code Compliance
<input type="checkbox"/> S6339RWA0LP	No	No	Yes	Adaptable**
<input type="checkbox"/> S6339RWA1LP	Yes	Yes	Yes	ADA, ANSI, CA Title 24, HUD/FHA

No-Recess Threshold Models

Model Number	Pre-Installed L-Shaped Grab Bar	Pre-Installed Folding Seat	Drain Block Out Required	Accessibility Code Compliance
<input type="checkbox"/> S6339RWA0NR	No	No	Yes	Adaptable**
<input type="checkbox"/> S6339RWA1NR	Yes	Yes	Yes	ADA, ANSI, CA Title 24, HUD/FHA

***Model is reinforced and capable of meeting accessibility code requirements with proper field-installation of grab bars and seat*

Return Wall Placement (indicated by '-L' or '-R' following model number)*

☐ Left Hand ☐ Right Hand

**Return wall placement is determined as if outside the unit looking in. For clarity, a right hand model is shown in all drawings*

Optional Accessories†

<input type="checkbox"/> Curtain Rod	<input type="checkbox"/> Shower Drain
<input type="checkbox"/> Shower Curtain	<input type="checkbox"/> 18" grab bar
<input type="checkbox"/> Recessed Soap Dish	<input type="checkbox"/> 24" grab bar
<input type="checkbox"/> Composite Corner Shelf	<input type="checkbox"/> Folding seat
<input type="checkbox"/> Shower Slide-Bar Kit	<input type="checkbox"/> T-shaped EverDam
<input type="checkbox"/> EverFab Tub-Wrap	

Accessory Style

- ☐ Thu-bolted (Standard)
- ☐ Flanged
- ☐ Elite Series
- ☐ Anti-ligature
- ☐ Custom, please specify:

Accessory Finish

- ☐ Satin Stainless (Standard)
- ☐ Matte Black
- ☐ Polished Stainless
- ☐ White
- ☐ Custom, please specify:

†If applicable, please select accessory style and finish from options above. If custom, please also indicate desired location(s) on drawing.